

Installation advice

Finishing and/or jointing profiles for Decochoc, Decoclean, Decowood and Decotrend panels

Fin'Color

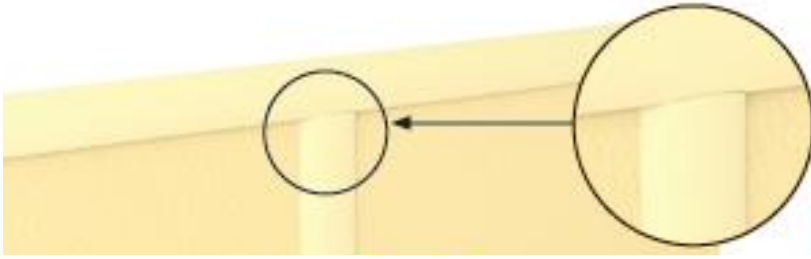

Prior to laying, it is recommended to refer to the Gerflor installation guide for fixing Decochoc, Decoclean, Decowood and Decotrend panels.

Fin'Color finishing profile is a PVC finishing profile, which is used in the following situations:

- Horizontal finishing at the top of 2 mm panels **1**
- Horizontal finishing for connecting 2 mm panels with a 2 mm flexible floor skirting **2**
- Vertical finishing for joining 2 mm panels **3** and **4**

Dimensions:

- Length: 3 m
- Width (visible part): 20.5 mm

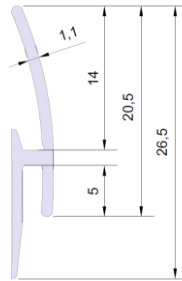

Fixing:

- Fin'Color profile is fixed to the wall using SPM acrylic adhesive or SPM multi-purpose sealant adhesive.
- Mechanical fixing using screws is not recommended.

Cutting:

- Fin'Color profile is flexible and can be easily cut using a cutter.
- For a clean finish, it is recommended to use gripper cutting pliers.



Horizontal laying:

1 Horizontal finishing at the top of 2 mm panels

- Cut out the Fin'Color profile to the length of the panel
- Place the Fin'Color profile on the top part of the panel
- Apply adhesive to the wall
- Apply the panel and the Fin'Color profile at the same time on the wall which has been coated with adhesive
- Smooth over the panel / Fin'Color assembly

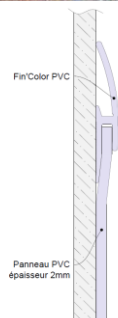

2 Horizontal finishing for connecting 2 mm panels with a 2 mm flexible floor skirting

- Cut out the Fin'Color profile to the length of the panel
- Place the Fin'Color profile on the lower part of the panel
- Apply adhesive to the wall
- Apply the panel and the Fin'Color profile at the same time on the wall which has been coated with adhesive, pressing on the skirting (detail A)
- Smooth over the panel /Fin'Color assembly

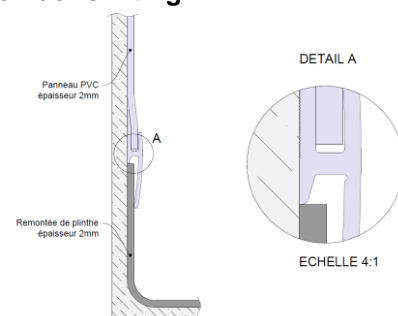

Installation advice

Finishing and/or jointing profiles for
Decochoc, Decoclean, Decowood
and Decotrend panels
Fin'Color

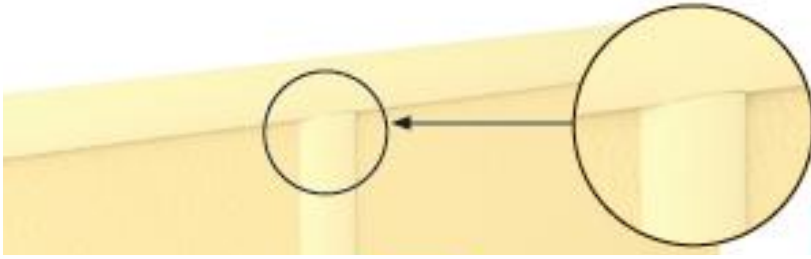

Vertical laying:

Important! For a perfect finish, and to ensure that the section of the Fin'Color profile is not visible, the Fin'color profile is laid vertically only to full-height panels or combined with a horizontal finish at the top of the panels.

③ Full-height vertical finishing for joining 2 mm panels

- Measure the length of the wall to be covered with 2 mm panels
- Remove 10 mm from this length for each Fin'Color profile used, so as to obtain the total height of the 2 mm panels to be applied
- Apply adhesive to the wall and glue the first panel
- Cut the Fin'Color profile to the width of the panel
- Place the Fin'Color profile on the vertical section of the second panel
- Apply adhesive to the wall
- Apply the second panel and the Fin'Color profile at the same time on the wall which has been coated with adhesive, pressing against the first 2 mm panel
- Smooth over the panel /Fin'Color assembly

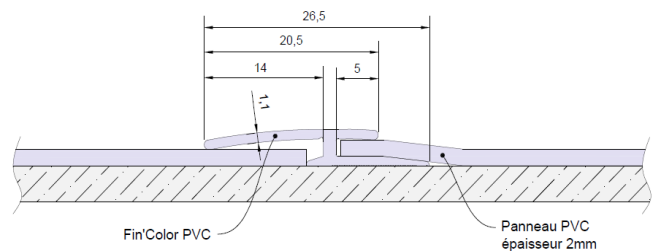

Combined Vertical and Horizontal laying:

Preparing Fin'Color profile

- Combined vertical and horizontal laying requires a manual modification of the Fin'Color profile.
- Using a cutter, make a 10 mm cut on the rear area of the Fin'Color profile; it is recommended to cut the area up to the front wall to avoid cracks (Fig. 1 and 2 below)
- Then remove the rear area using a pincer (Fig.3 to 5 below)

Fig. 1



Fig. 2

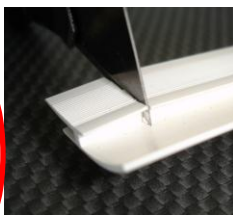

Fig. 3



Fig. 4

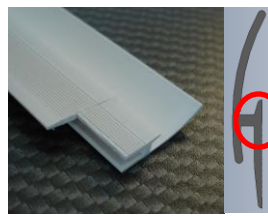
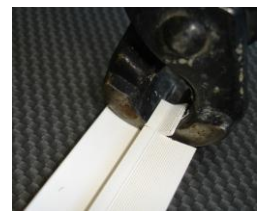
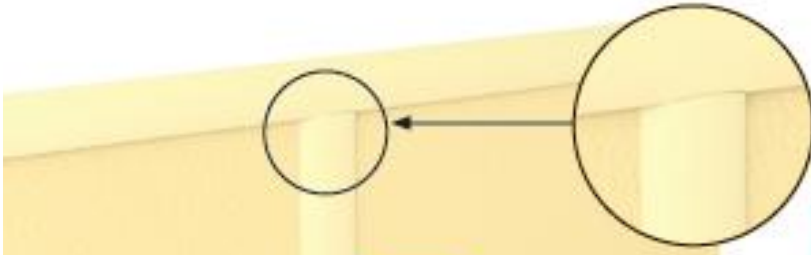

Fig. 5



Installation advice



Finishing and/or jointing profiles for
Decochoc, Decoclean, Decowood
and Decotrend panels

Fin'Color

Laying of 2 mm panels and Fin'Color profiles

- Measure the length of the wall to be covered with 2 mm panels
- Remove 10 mm from this length for each Fin'Color profile used, so as to obtain the total height of the 2 mm panels to be applied (Fig. 6 below)
- Apply adhesive to the wall and glue the first panel
- Measure the length of the 2 mm panel over its section and remove 5 mm to obtain the length of the Fin'Color profile in vertical position
- Make a 10 mm cut on the Fin'Color profile at its end (see above "Preparing the Fin'Color profile")
- Once the cut is made, position the Fin'Color profile on the section of the second panel leaving 5 mm uncovered on the top end of the 2 mm panel (Fig. 7 below)
- Glue the second panel and the Fin'Color profile at the same time on the wall which has been coated with adhesive, pressing against the first 2 mm panel
- Cut the horizontal Fin'Color profile to the dimension of the 2 mm panel in the top part
- Place the horizontal Fin'Color profile (Fig. 8 below)
- Smooth over the panel /Fin'Color assembly

Fig. 6

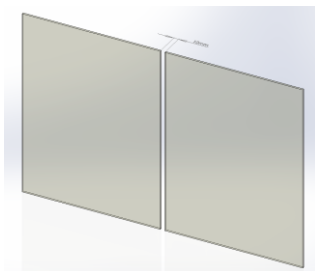

Fig. 7

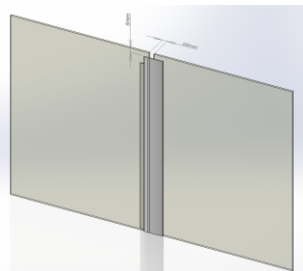

Fig. 8

